



VELA™ ventilator



NOTE: The VELA™ ventilator's quick tips card is not intended to replace the operator manual.

You must become completely familiar with the operator manual before using the VELA ventilator.

User interface

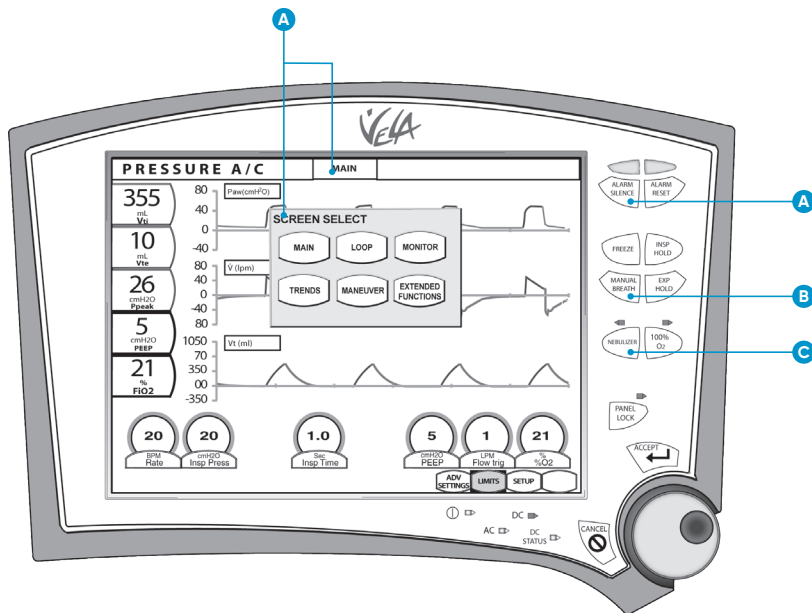

- A. Alarm silence:** 2-minute silence period.
- B. Manual breath:** Delivers a single breath at current control settings.
- C. Nebulizer:** 30 minutes, synchronized with inspiration. Delivered volumes and FiO_2 may be affected. Refer to operator's manual for full description.
- D. Screen indicator:** Identifies current screen. When pressed, opens the **SCREEN SELECT** menu.



User interface (continued)

Touch-Turn-Touch™ and Touch-Turn-Accept™ method

- 1. Touch the control to select. The control changes color, indicating it is active.
- 2. Turn the data dial to reach the selected value.
- 3. Touch the control again, or press **ACCEPT** to confirm the change.

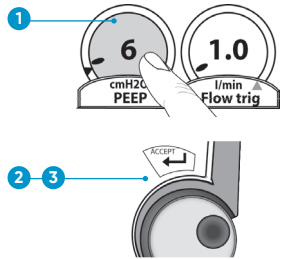

Setting alarm limits

- 1. Press **LIMITS** to open or close the window.
- 2. Use the Touch-Turn-Touch or Touch-Turn-Accept method to modify alarms.

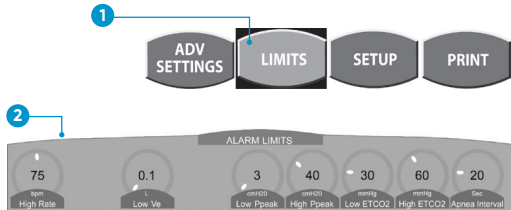

Trends

Press the screen indicator. Select TRENDS. Use the Touch-Turn-Touch or Touch-Turn-Accept method to configure histograms and spreadsheet columns from monitored parameters and to scale histograms. To view trends over time, press **FREEZE**. Use the data dial to scroll back in time.

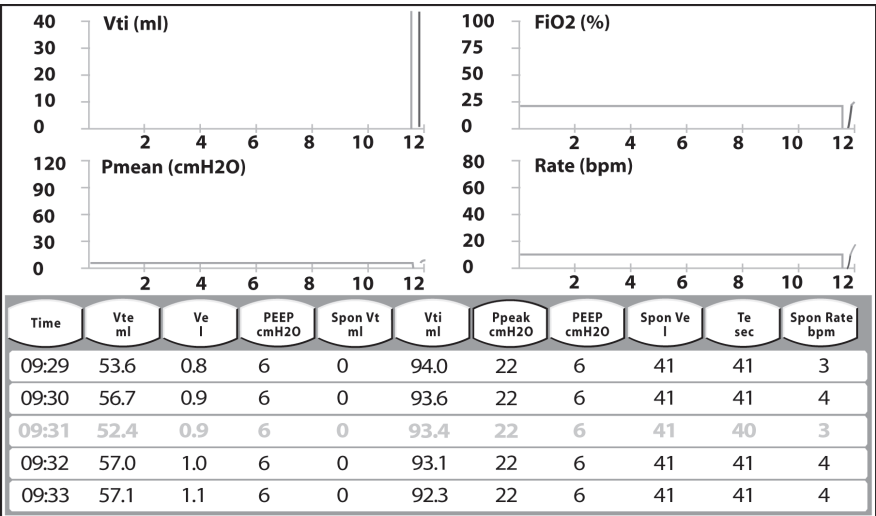



GLOBAL HEADQUARTERS

Vyaire Medical, Inc.
26125 North Riverwoods Blvd
Mettawa, IL 60045
USA

vyaire.com

© 2020 Vyaire. Vyaire, the Vyaire logo and all other trademarks or registered trademarks are property of Vyaire Medical, Inc., or one of its affiliates. Please read the complete Instructions For Use that come with the devices or follow the instructions on the product labelling. VYR-GBL-2000165